

# Instructions, Use & Care Manual

(Please keep the manual for further reference)

## PACKAGE CONTENTS

-  Includes (1) AA 1.2V 800mAh NI-MH rechargeable battery
- LED** Includes (1) Filament LED. The lifetime for LEDs is estimated to be 100,000 hours.

REF.	PARTS NAME
A	Polycrystalline Solar Panel
B	Glass Lampshade with Frame
C	Connection Tube
D	Ground Stake

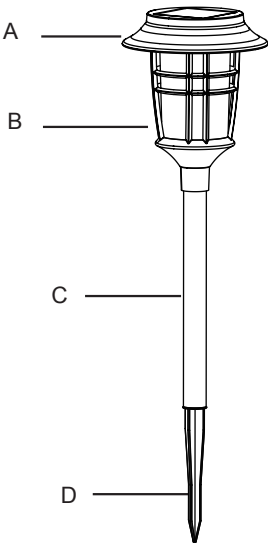

**⚠ Please carefully read before assembly. Failure to do so may result in faulty assembly and potential injury.**

**FUNCTION:** The built-in solar panels convert sunlight into electricity. The rechargeable battery stores the energy and converts the power into light for use during the night. The lighting hours of the solar light depends on the geographical location and weather condition. Stronger or longer exposure to sunlight enables the battery to store more energy and provide longer lighting hours.

**LOCATION:** It is important to select an outdoor location full, direct sunlight where the solar panel can receive at least 8 hours of sunlight each day. Shady areas will not enable batteries to be fully charged. This will reduce the lighting hours at night. It is also important to avoid placing the solar light by light sources, such as street lights or porch lights, which may cause the solar light to turn off automatically. The solar light is designated for outdoor usage and ideal for night lighting of garden, paths, etc.

**CLEANING AND MAINTENANCE:** Please use a damp cloth to clean the solar panel. Do not use any chemical or abrasive cleaner. It is important to ensure that no moisture enters into the solar light. Replacement parts may be ordered by using the fixture model number and part's name; Contact the email located at the top and bottom of this instruction manual.

**RECHARGEABLE BATTERY:** This product contains (1) AA 1.2V 800mAh NI-MH rechargeable battery. When the battery expires, it must be recycled or disposed of properly. Please contact your local waste disposal authority the correct procedure. Do not put the into fire.



## ASSEMBLY AND BATTERY REPLACEMENT INSTRUCTIONS

### ASSEMBLY (Figure 1)

- Gently remove all parts from the package and lay them out on a smooth surface.
- Attach the Glass Lens with Frame (Part B) to the Solar Panel Unit (Part A) by twisting.
- Insert the Glass Lens with Frame (Part B) into the Connection Tube (Part C).
- Place the assembled light on top of the ground stake (Part D).
- Choose the ground area where you would like to place the light.
- **Never push the fixture into the ground by the fixture head.**

**CAUTION:** In compacted, clay, or hard soils, moisten the ground with water before inserting the stake into the ground to avoid breakage.

### OPERATIONAL INSTRUCTIONS (Figure 2)

- Before attaching the Solar Panel Unit (Part A) to the Glass Lens with Frame (Part B), pull out the isolated tag which is on the bottom of the Solar Panel Unit (Part A) as shown in Figure 2.
- After assembling, take the light to direct sunlight that allows the rechargeable battery to reach its maximum capacity. Ensure the light is in full sunlight for 8 hours. The unit will then automatically light up at dusk.

Figure 1

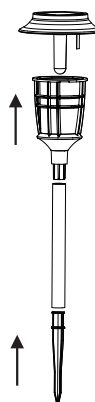

Figure 2

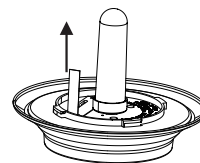
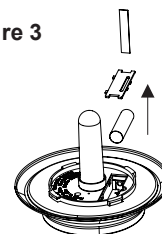

Figure 3



### CHANGING BATTERIES (Figure 3)

- Twist counter clockwise and detach the Solar Panel Unit (Part A) from the Glass Lens with Frame (Part B) to expose the battery compartment.
- Open the battery chamber cover on the bottom of Solar Panel Unit (Part A). Figure 3.
- Replace the old battery with new battery. Make sure the polarity is correct.
- Reposition the battery cover tightly.

## TROUBLESHOOTING

### The light does not come on at night:

- ✓ Make sure the isolated tag was pulled out.
- ✓ Check the rechargeable battery and make sure that it is in contact with the metal plate and the polarity is correct. If the battery is worn out, replace the battery with a AA 1.2V 800mAh NI-MH rechargeable battery.
- ✓ Always keep the solar light distant from other night light sources, such as exterior lights. Reposition the light to avoid close contact with other night light sources.
- ✓ Make sure solar panel is clean and free of dirt and debris. If needed use a damp cloth to clean the solar panel. Do not use any chemical or abrasive cleaner. It is important to ensure that no moisture enters into the solar light.

### Lighting hours are short:

- ✓ Check the location of the solar light. Make sure it is in a sunny area, and the battery can be fully charged during day time.